

ET-52900 SERIES

Common Mode Chokes For Three —phase power lines



uctance with a low number of turns.

R , Lower loss.

- Winding to winding isolation 3000 Vrms for 1 sec.
- Turn ratio 1 : 1 : 1.

Type : A

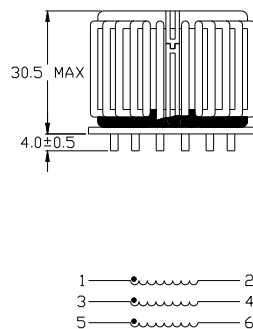
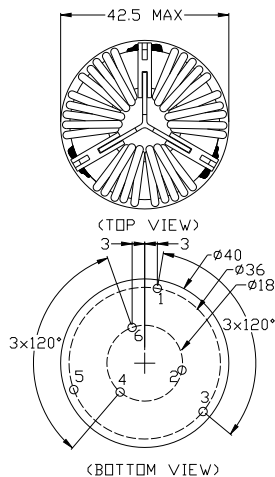

Type : B

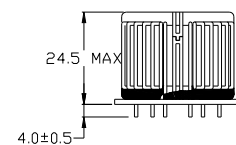
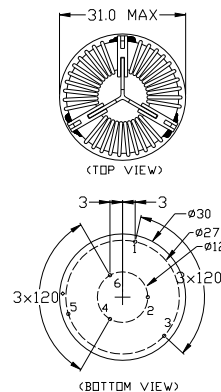

UNIT : mm

| Part Number. | Inductance (mH MIN) | DCR 25°C (mΩ Max) | Rated current Iac(A) | Wire Size (mm) | TYPE |
|--------------|------------------------|----------------------|-------------------------|-------------------|------|
| ET-52901 | 2.0 | 11 | 5.0 | 1.0 | B |
| ET-52902 | 2.6 | 15 | 4.0 | 0.9 | B |
| ET-52903 | 3.3 | 21 | 3.0 | 0.8 | B |
| ET-52904 | 5.0 | 7 | 10.0 | 1.6 | A |
| ET-52905 | 8.4 | 14 | 8.0 | 1.3 | A |
| ET-52906 | 12.7 | 28 | 6.0 | 1.1 | A |

1. Inductance tested at 10KHz / 0.1Vrms.
2. Operating temperature range -40°C to +130°C.
3. Electrical specifications at 25°C